

# Spin Tongue and Groove Shear Joint - Single

Customer Name: \_\_\_\_\_ Date: \_\_\_\_\_

Application Number: \_\_\_\_\_ Revision: \_\_\_\_\_

Project: \_\_\_\_\_

Material: \_\_\_\_\_

Prepared By: \_\_\_\_\_ Email: \_\_\_\_\_

	Dimension	General Guidelines	Recommended Size
W	Wall Thickness	Minimum 0.150"	
B	Shear Length	0.020" – 0.080" and/or 1.5•S	
A	Shear Width	0.016" – 0.030"	
T	Tongue Width	W/3	
H	Tongue Height	L+B and/or W/3	
L	Lead-In Depth	Minimum 0.020"	
G	Groove Width	(T – A) + C	
D	Groove Depth	H + 0.015"	
S	Groove Side Wall Width	Minimum 0.050"	
C	Clearance	0.005" per side	

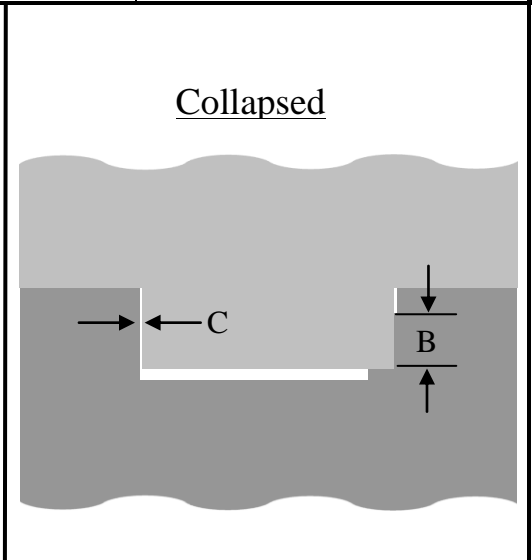
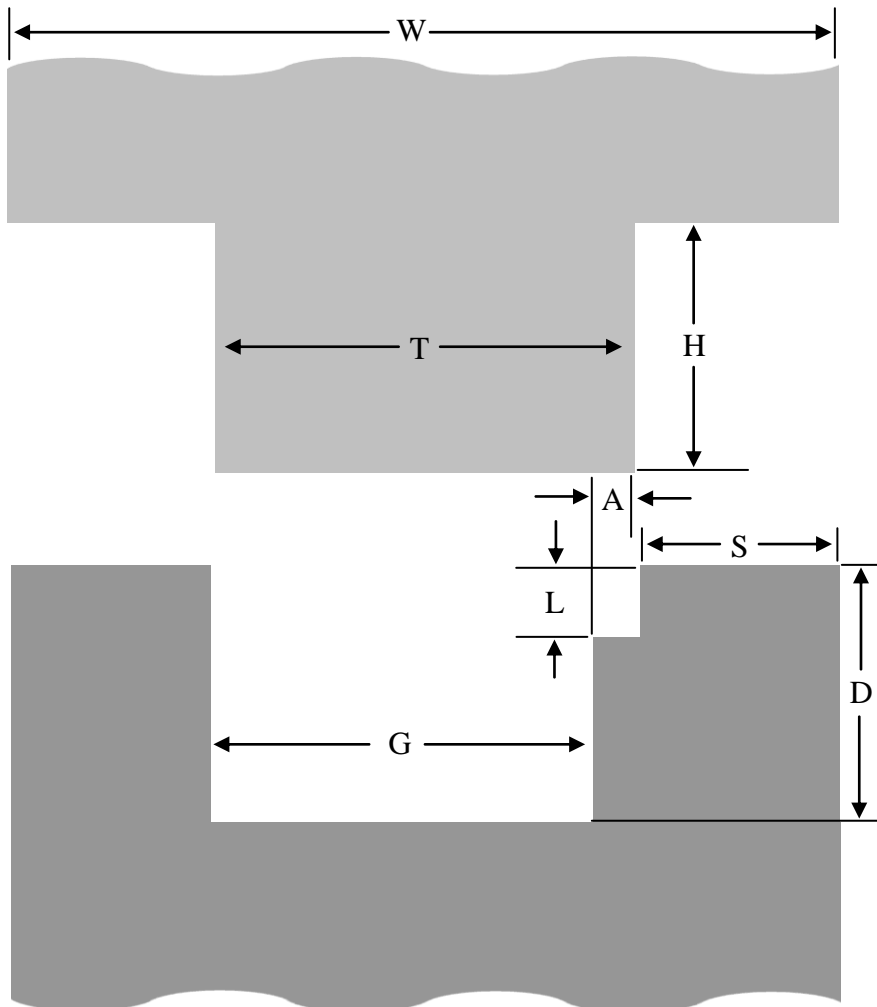

## Dukane Corporation

*Intelligent Assembly Solutions*

2900 Dukane Drive  
 St. Charles, IL 60174  
 (630) 797-4900

<http://www.dukcorp.com/us>  
[us\\_caddata@dukcorp.com](mailto:us_caddata@dukcorp.com)